

# CITY PARK STORMWATER OVERFLOW BASIN, FÜRTH

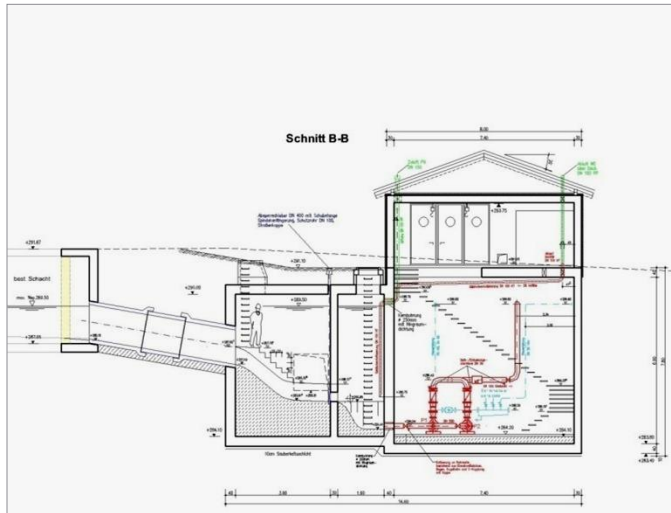

## City Park Stormwater Overflow Basin, City of Fürth, Germany

### Services provided

Planning and tendering  
Site supervision for construction  
technology and technical equipment  
Structural design

### Technical details

New construction of stormwater overflow basin in Fürth City Park:  
effective volume  $V = 1\,000\text{ m}^3$ ,  
approx. 180 m of relief sewer,  
pumping unit with building  
component, approx. 120 m of  
pressure sewer DN 250,  
pumping capacity  $Q = 35\text{ l/s}$ , with  
automatic basin purification

